

# CONFEDERATED TRIBES OF THE UMATILLA INDIAN RESERVATION

## HOUSING OFFICE ACCESS IMPROVEMENTS

### 2023

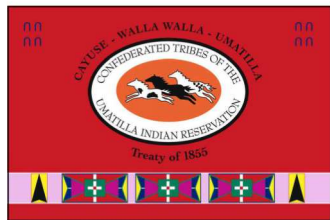
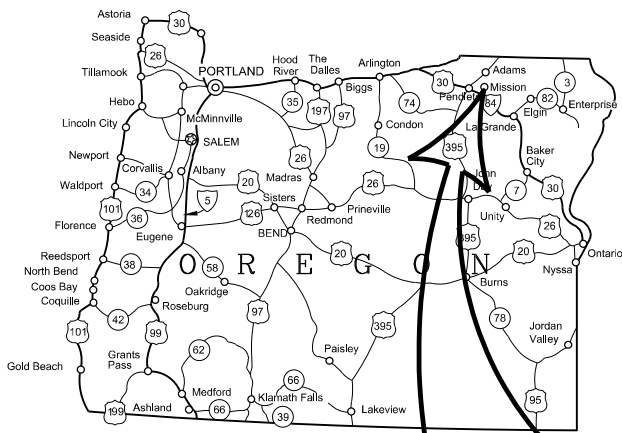

#### BOARD OF TRUSTEES

KAT BRIGHAM, Board of Trustees Chairman  
AARON ASHLEY, Vice Chairman  
SANDRA SAMPSON, Treasurer  
SALLY KOSEY, Secretary  
CORRINE SAMS, Member  
TOBY PATRICK, Member  
LISA GANUELAS, Member  
BOOTS POND, Member  
LINDSEY X. WATCHMAN, General Council Chair

#### EXECUTIVE DIRECTOR

DONALD SAMPSON, Executive Director

#### PUBLIC WORKS DEPARTMENT

JUSTIN NORTHERN, Public Works Director

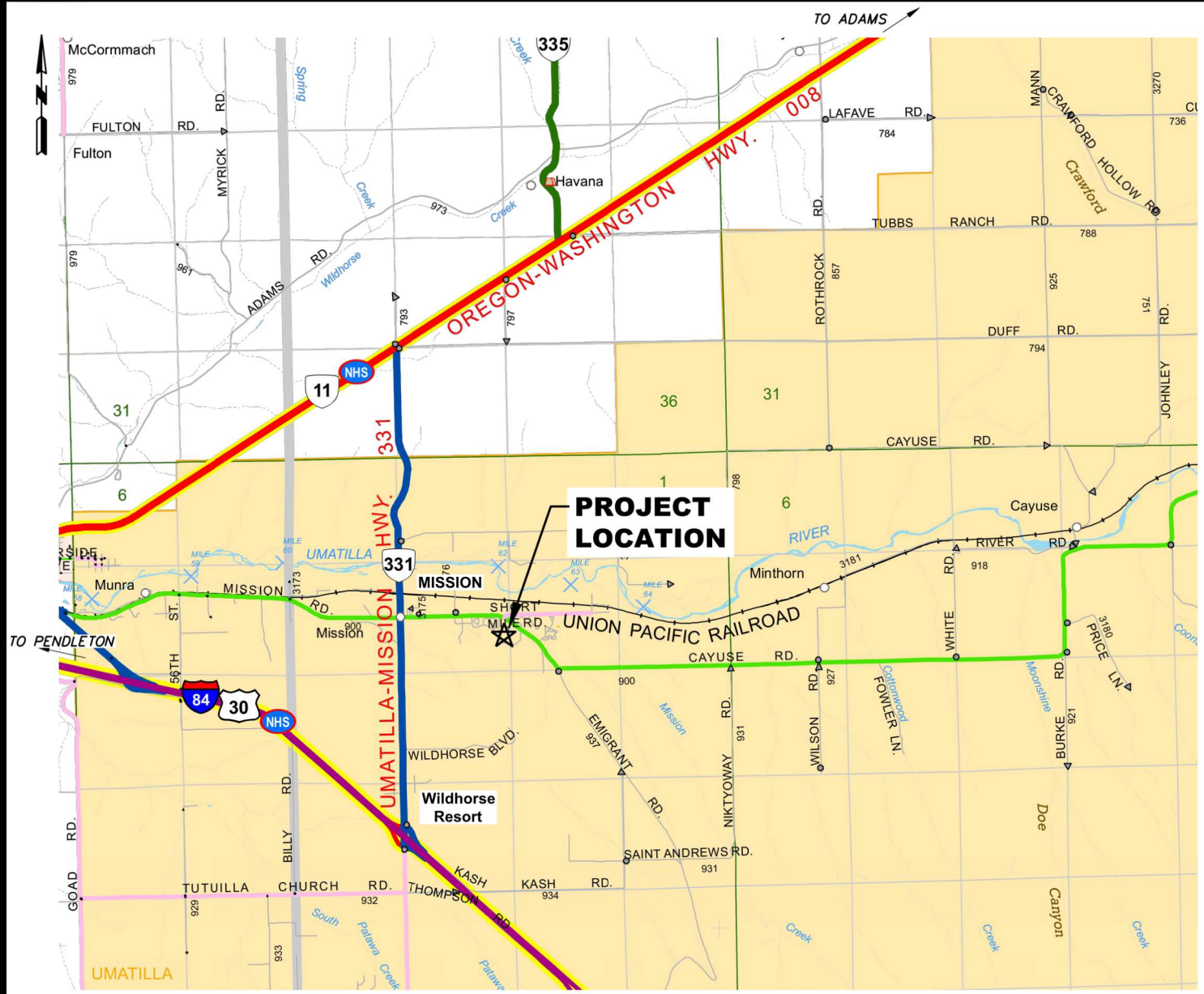

VICINITY MAP  
N. T.S.

#### INDEX

- COVER
- G-001 LEGEND AND GENERAL NOTES
- G-100 EXISTING SITE PLAN AND SURVEY CONTROL
- D-101 DEMOLITION PLAN
- SITE
- C-101 LAYOUT PLAN
- C-102 GRADING PLAN
- C-501 DETAILS I
- C-502 DETAILS II
- STORMWATER
- R-101 PLAN AND PROFILE
- R-401 DRAINAGE SWALE PLAN AND SECTION
- R-501 DETAILS

#### OREGON STANDARD DRAWINGS

- RD 770 METAL HANDRAIL
- TM 500 PAVEMENT MARKING STANDARD DETAIL BLOCKS



1901 N. Fir Street - La Grande, OR 97850 Ph: (541)963-8309 Fax: (541)963-5456  
LA GRANDE, OR. WALLA WALLA, WA. REDMOND, OR. HERMISTON, OR.  
COPYRIGHT 2023 BY ANDERSON PERRY & ASSOCIATES, INC.

PLAN LEGEND

SITE SURVEY		
	EXISTING	PROPOSED
INDEX CONTOUR	—————750—————	—————750—————
INTERMEDIATE CONTOUR	—————749—————	—————749—————
PROPERTY LINE/ RIGHT-OF-WAY	————— — — —————	————— — — —————
CENTERLINE	————— — — —————	————— — — —————
CONTROL POINT		
MAILBOX		
SPRINKLER HEAD		
IRRIGATION VALVE		
MISCELLANEOUS POST		

UTILITES		
	EXISTING	PROPOSED
WATER LINE	— — — — W — — — — W —	—————6"W—————
VALVE		
FIRE HYDRANT		
WATER METER		
STORM DRAIN	—————SD—————	—————6"SD—————
STORM DRAIN MANHOLE		
CATCH BASIN		
BURIED POWER	— P — P — P —	— P — P — P —
OVERHEAD POWER	— OHP — OHP —	— OHP — OHP —
BURIED TELEPHONE	— T — T — T —	— T — T — T —
GAS SERVICE	—————G—————	—————G—————
IRRIGATION	—————IRR—————	—————IRR—————
UTILITY POLE		
GUY WIRE		
ELECTRIC TRANSFORMER		
STREET LIGHT		
DECIDUOUS TREE		
BUILDING		

STREET AND CURB

	EXISTING	PROPOSED
CURB AND SIDEWALK		
PAVED STREET	—————1ST ST.—————	—————1ST ST.—————
GRAVEL DRIVEWAY/STREET		

DRAFTING

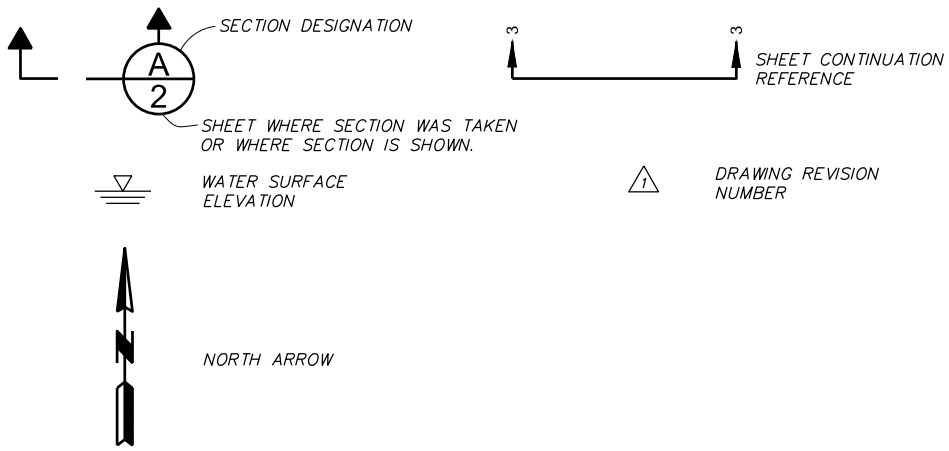

GENERAL NOTES

- ALL WORK SHALL BE PERFORMED IN ACCORDANCE WITH THE CONTRACT DOCUMENTS, AND DRAWINGS.
- INFORMATION SHOWN ON THE PLAN IS SCHEMATIC IN NATURE. THE RELATIVE LOCATION OF EXISTING FEATURES ARE APPROXIMATE ONLY AND IT SHOULD BE NOTED THAT SOME DISCREPANCIES AND OMISSIONS IN LOCATION, TYPE, AND SIZE WILL OCCUR. THE EXACT LOCATION OF EXISTING FEATURES WILL REQUIRE FIELD VERIFICATION IN AREAS WHERE CONFLICT MAY OCCUR. FEATURES SHOWN ARE FOR THE CONVENIENCE OF THE CONTRACTOR. THIS VERIFICATION WORK SHALL BE PERFORMED PRIOR TO PERFORMING ANY NEW WORK TO ENSURE THAT CONFLICTS WITH THE EXISTING FEATURES DO NOT OCCUR. ADJUSTMENTS TO THE LOCATION OF THE NEW IMPROVEMENTS OR RELOCATION OF EXISTING FEATURES MAY BE NECESSARY TO PREVENT CONFLICTS. ALL ADJUSTMENTS SHALL BE REVIEWED AND APPROVED BY THE ENGINEER. THIS WORK SHALL BE CONSIDERED INCIDENTAL AND NO ADDITIONAL PAYMENT WILL BE MADE.
- ANY CONSTRUCTION STAKING NOT PROVIDED BY THE ENGINEER AND NEEDED BY THE CONTRACTOR TO COMPLETE THE IMPROVEMENTS AS SHOWN WILL BE THE RESPONSIBILITY OF THE CONTRACTOR TO PROVIDE. SEE "CONSTRUCTION STAKING" SECTION OF GENERAL REQUIREMENTS FOR ADDITIONAL INFORMATION.
- THE CONTRACTOR SHALL BE RESPONSIBLE FOR THE ACTUAL LOCATION AND PROTECTION OF EXISTING UTILITIES. PRIOR TO THE COMMENCEMENT OF WORK, THE CONTRACTOR SHALL CONTACT EXISTING UTILITY COMPANIES FOR LOCATION OF ALL UTILITIES AFFECTED BY THE WORK. THE CONTRACTOR SHALL UTILIZE THE ONE CALL UTILITY NOTIFICATION CENTER AT 1-800-332-2344 OR 811.
- SURFACE RESTORATION WORK TO BE PERFORMED IS NOT SPECIFICALLY CALLED OUT ON THE DRAWINGS. THE INTENT IS TO RESTORE ALL AREAS ADJACENT TO THE WORK AREA TO AN EQUIVALENT OR BETTER CONDITION THAN EXISTED PRIOR TO CONSTRUCTION.
- CONTRACTOR IS RESPONSIBLE FOR MAINTAINING OR PROVIDING ACCESS TO ALL BUSINESSES AND RESIDENCES DURING CONSTRUCTION. APPROPRIATE METHODS OF PEDESTRIAN AND VEHICULAR TRAFFIC CONTROL, INCLUDING FLAGGERS, SHALL BE USED BY THE CONTRACTOR TO THE EXTENT DEEMED NECESSARY BY THE CONTRACTOR TO PROTECT WORKERS OR THIRD PARTIES.
- SAW CUT ALL EXISTING ASPHALT AND CONCRETE WHERE JOINTS WITH NEW CONSTRUCTION WILL OCCUR.
- THE CONTRACTOR SHALL KEEP THE SITE IN A NEAT AND ORDERLY CONDITION. ALL TRASH GENERATED BY THE CONTRACTOR'S OPERATIONS SHALL BE PICKED UP AT THE END OF EACH DAY. EQUIPMENT, VEHICLES, AND MATERIALS SHALL BE STAGED EITHER OFF SITE OR ALONG SAFE PULL OFF SECTIONS OF THE ROAD.

ABBREVIATIONS

BOW	BACK OF WALK
EL	ELEVATION
EXTG	EXISTING
FG	FINISH GRADE
FL	FLOW LINE
FT	FOOT
PT	POINT
TBC	TOP BACK CURB

X:\Clients\CTUR - Public Works\152-214 Housing Office Access\CAD\152-214-G-001.dwg, Layout1, 8/30/2023 2:35 PM, gillmore



REVISION		BY	DATE
DESIGNED BY	G. BANISTER		
DRAWN BY	L. WILLHITE		
REVIEWED BY	A. LINDSEY		
JOB NUMBER	152-214	DATE	2023
ACAD FILE:	152-214-G-001.dwg		
COPYRIGHT 2023 BY ANDERSON PERRY & ASSOC., INC.			



CONFERATED TRIBES OF THE  
UMATILLA INDIAN RESERVATION  
HOUSING OFFICE ACCESS IMPROVEMENTS

LEGEND AND GENERAL NOTES

SHEET

G-001

1 OF 10







DEMOLITION WORK ITEMS

- 1 REMOVE ASPHALT CONCRETE PAVEMENT
- 2 REMOVE CONCRETE CURB
- 3 REMOVE CONCRETE SIDEWALK
- 4 REMOVE HANDRAIL
- 5 REMOVE EXISTING IRRIGATION, COORDINATE WITH OWNER TO CAP EXISTING IRRIGATION LINES AS REQUIRED
- 6 REMOVE LAWN AND LANDSCAPING
- 7 REMOVE TREE
- 8 PROTECT MAILBOX
- 9 PROTECT UTILITY POLE
- 10 REMOVE AND RE-INSTALL ADA PUSH BUTTON
- 11 REMOVE MAILBOX
- 12 PROTECT AC UNIT
- 13 PROTECT TREE
- 14 REMOVE RETAINING WALL

NOTE  
WORK ITEMS NOTED AS (#) A/B ARE INCLUDED IN ADDITIVE ALTERNATIVE A OR B RESPECTIVELY.

DEMOLITION LEGEND

- REMOVE ACP AND EXCAVATE TO SUBGRADE
- REMOVE CEMENT CONCRETE
- REMOVE EXISTING LAWN AND LANDSCAPING
- SAW CUT LINE
- REMOVE CURB OR RETAINING WALL
- REMOVE HANDRAIL
- REMOVE EXISTING SPRINKLER
- REMOVE EXISTING TREE

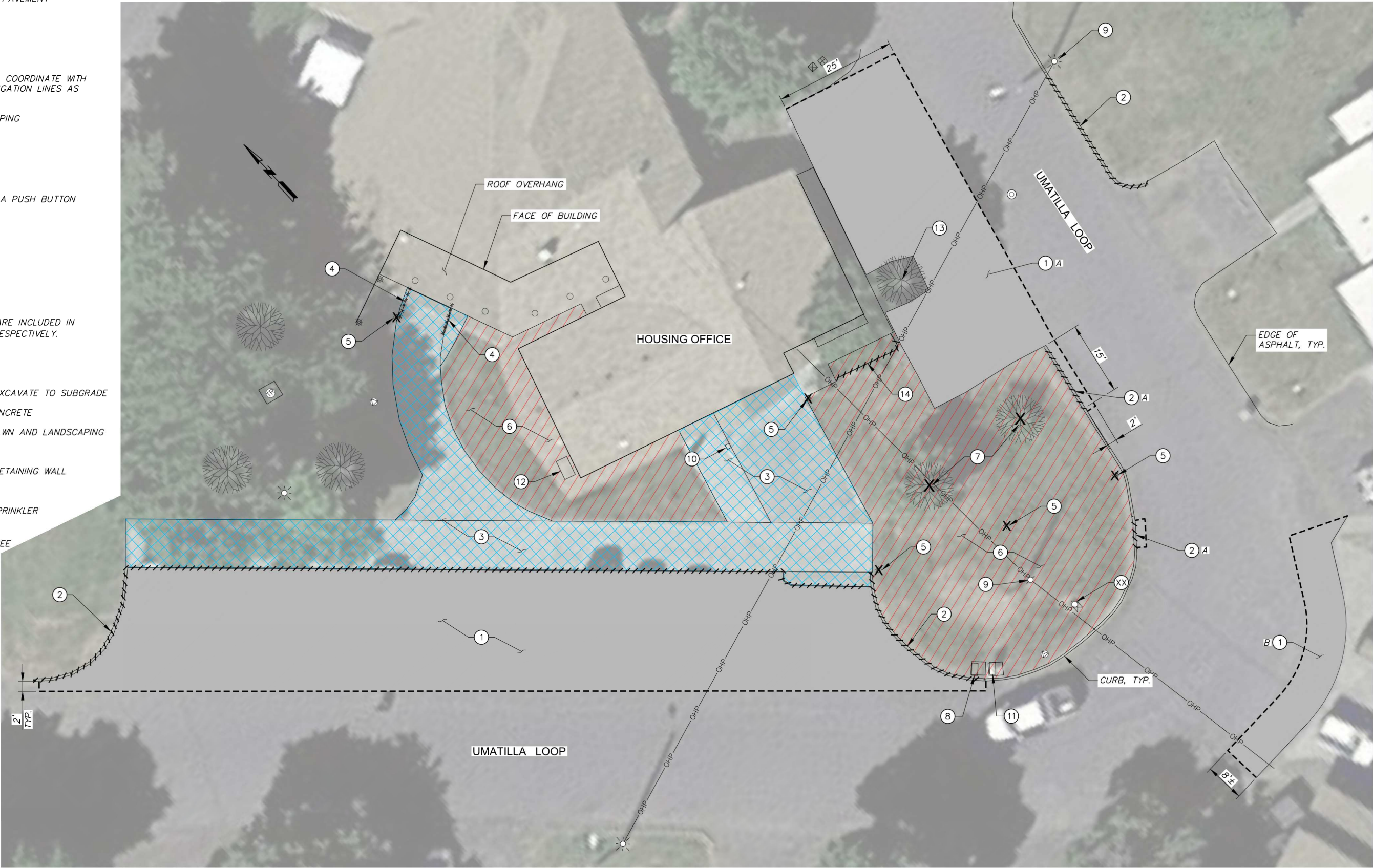

REVISION	BY	DATE
DESIGNED BY: G. BANISTER		
DRAWN BY: L. WILLHITE		
REVIEWED BY: A. LINDSEY		

JOB NUMBER: 152-214	DATE: 2023
ACAD FILE: 152-214-D-101.dwg	
COPYRIGHT 2023 BY ANDERSON PERRY & ASSOC., INC.	



CONFERATED TRIBES OF THE  
UMATILLA INDIAN RESERVATION  
HOUSING OFFICE ACCESS IMPROVEMENTS

DEMOLITION PLAN

SHEET

D-101

3 OF 10



WORK ITEMS

- 1 CONSTRUCT ASPHALT CONCRETE PAVEMENT PARKING AREA  
SEE TYPICAL SECTION, SHEET C-501
- 2 CONSTRUCT CONCRETE SIDEWALK  
SEE DETAILS, SHEET C-501
- 3 CONSTRUCT CURB RAMP  
SEE DETAILS, SHEET C-502
- 4 CONSTRUCT CONCRETE CURB  
SEE DETAILS, SHEET C-501
- 5 CONSTRUCT CONCRETE CURB AND GUTTER  
SEE DETAIL, SHEET C-501
- 6 INSTALL PARKING BUMPER  
SEE DETAIL, SHEET C-502
- 7 RELOCATE EXISTING MAILBOX TO BACK OF SIDEWALK
- 8 REINSTALL ADA PUSH BUTTON
- 9 INSTALL XERISCAPE LANDSCAPING (BY OTHERS)
- 10 INSTALL 2 RAIL HANDRAIL  
SEE OREGON STD DWG RD 770 FOR DETAIL
- 11 INSTALL SIGN  
SEE PARKING SPACE DETAIL, SHEET C-502

NOTE  
WORK ITEMS NOTED AS # A/B ARE INCLUDED IN ADDITIVE ALTERNATIVE A OR B RESPECTIVELY.

STRIPING WORK ITEMS

- W 4" WHITE LINE
- HC DISABLED PARKING DETAIL (WHITE)
- CW STANDARD CROSSWALK (TWO 1' WHITE LINES)

NOTE  
FOR STRIPING DETAILS, SHEET C-502 AND OREGON STANDARD DRAWING TM500 AND TM503

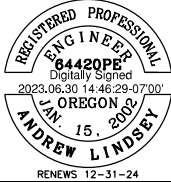
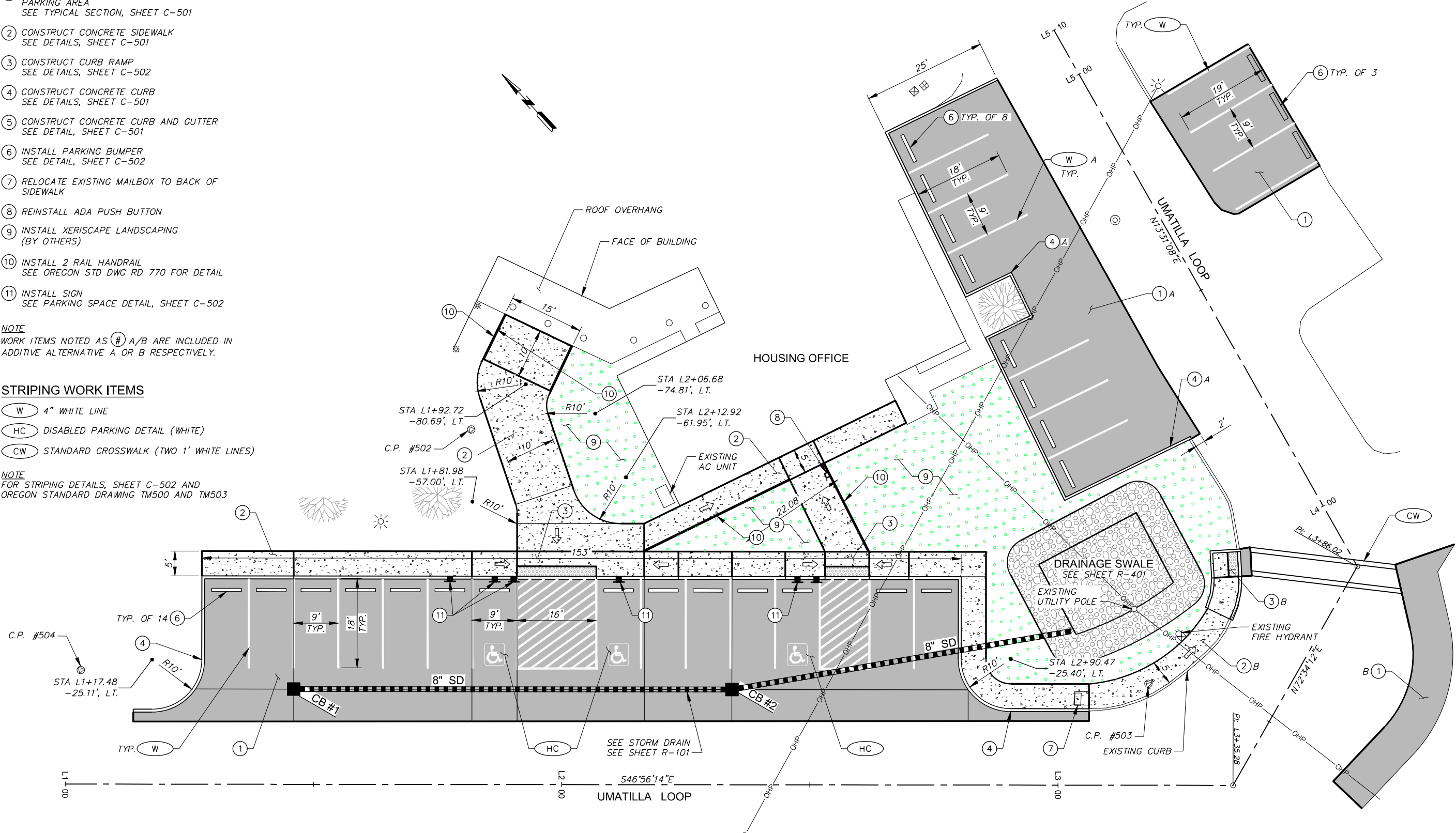

				<div><div><div></div><div></div><div></div><div></div><div></div></div><div>1000102030</div><div>SCALE IN FEET</div></div>	
REVISION		BY	DATE		
DESIGNED BY <i>G. BANISTER</i>				JOB NUMBER 152-214	DATE 2023
DRAWN BY <i>L. WILLHITE</i>				ACAD FILE: 152-214-C-101.dwg	
REVIEWED BY <i>A. LINDSEY</i>				COPYRIGHT 2023 BY ANDERSON PERRY & ASSOC., INC.	

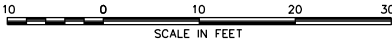

CONFERATED TRIBES OF THE  
UMATILLA INDIAN RESERVATION  
HOUSING OFFICE ACCESS IMPROVEMENTS

SITE  
LAYOUT PLAN



X:\Clients\CTUR - Public Works\152-214-C-102.dwg Layout1, 6/30/2023 2:36 PM, cglmore

FINISHED POINT DATA				
NO.	NORTHING	EASTING	ELEV.	DESC.
1	734534.25	8670015.90	1240.29	FG
2	734520.30	8670021.40	1240.69	FG
3	734530.70	8670006.55	1240.91	FG
4	734516.63	8670012.09	1240.83	FG
5	734518.69	8669997.67	1240.37	FG
6	734513.73	8670008.60	1240.61	FG
7	734504.74	8669991.35	1239.65	FG
8	734499.79	8670002.28	1239.89	FG
9	734501.77	8669988.94	1239.47	FG
10	734484.26	8670007.64	1239.62	FG
11	734467.90	8670061.56	1240.87	FG
12	734463.12	8670060.10	1240.77	FG
13	734473.25	8670043.94	1241.05	FG
14	734468.46	8670042.49	1240.95	FG
15	734475.49	8670036.54	1241.05	FG
16	734470.71	8670035.09	1240.95	FG
17	NOT USED			
18	NOT USED			
19	734541.00	8669938.70	1239.56	BOW
20	734537.35	8669935.28	1239.48	TBC
21	734536.52	8669935.31	1238.98	FL
22	734524.72	8669948.80	1239.52	TBC
23	734524.29	8669948.40	1238.87	FL
24	734503.86	8669978.44	1239.67	BOW
25	734500.20	8669975.04	1239.59	TBC
26	734499.77	8669974.64	1239.09	FL
27	734497.65	8669985.09	1239.36	BOW
28	734493.99	8669981.67	1239.26	TBC
29	734493.57	8669981.27	1239.25	FL
30	734480.16	8670003.80	1239.51	BOW
31	734476.50	8670000.39	1239.41	TBC
32	734476.07	8669999.99	1239.40	FL
33	734475.44	8670008.85	1239.88	BOW
34	734471.79	8670005.43	1239.81	TBC
35	734471.36	8670005.03	1239.31	FL
36	734468.07	8670016.72	1239.90	BOW
37	734464.42	8670013.31	1239.83	TBC
38	734464.00	8670012.92	1239.16	FL
39	734460.75	8670024.57	1239.93	BOW
40	734457.09	8670021.16	1239.85	TBC
41	734456.67	8670020.76	1239.35	FL
42	734455.28	8670030.41	1239.61	BOW
43	734451.63	8670027.00	1239.51	TBC
44	734451.21	8670026.60	1239.50	FL

FINISHED POINT DATA				
NO.	NORTHING	EASTING	ELEV.	DESC.
45	734449.20	8670036.93	1239.65	BOW
46	734445.54	8670033.51	1239.55	TBC
47	734445.12	8670033.12	1239.54	FL
48	734443.74	8670042.77	1240.16	BOW
49	734440.08	8670039.36	1240.08	TBC
50	734439.66	8670038.96	1239.58	FL
51	734433.13	8670054.12	1240.23	BOW
52	734432.89	8670047.06	1240.13	TBC
53	734432.86	8670046.23	1239.63	FL
54	734429.48	8670050.71	1240.16	BOW
55	734527.12	8669906.85	1238.79	TBC
56	734526.70	8669906.45	1238.29	FL
57	734525.29	8669905.14	1238.29	FG
58	734525.01	8669923.75	1238.92	TBC
59	734521.53	8669918.82	1238.22	FL
60	734508.03	8669933.26	1238.12	FG
61	734503.25	8669928.80	1238.30	FG
62	734483.51	8669959.50	1238.76	FG
63	734478.77	8669955.08	1238.50	FG
64	734477.31	8669966.13	1238.80	FG
65	734472.58	8669961.73	1238.54	FG
66	734459.82	8669984.85	1238.95	FG
67	734455.12	8669980.48	1238.70	FG
68	734447.76	8669997.75	1238.72	FG
69	734443.09	8669993.39	1238.76	FG
70	734413.36	8670038.06	1239.79	BOW
71	734415.18	8670033.11	1239.76	TBC
72	734415.26	8670032.53	1239.18	FL
73	734410.64	8670028.23	1238.90	FG
74	734406.20	8670035.81	1239.00	FL
75	734399.58	8670051.07	1239.42	BOW

FINISHED POINT DATA				
NO.	NORTHING	EASTING	ELEV.	DESC.
76	734395.85	8670047.74	1239.35	TBC
77	734395.42	8670047.34	1239.09	FL
78	734394.03	8670046.05	1239.14	FG
79	734394.81	8670078.84	1239.80	TBC
80	734394.34	8670079.02	1239.80	FG
81	734389.69	8670080.84	1239.60	TBC
82	734397.96	8670084.15	1239.55	FG
83	734398.28	8670083.76	1240.06	TBC
84	734394.78	8670088.00	1239.48	TBC
85	734394.41	8670088.45	1239.47	FL
86	734401.82	8670087.33	1239.63	FG
87	734402.53	8670087.26	1240.13	TBC
88	734398.64	8670091.19	1239.56	FG
89	734398.72	8670091.88	1240.06	TBC
90	734389.14	8670081.05	1239.33	FL

FINISHED POINT DATA				
NO.	NORTHING	EASTING	ELEV.	DESC.
91	734423.82	8670084.14	1239.92	FG
92	734417.69	8670087.68	1239.84	FG
93	734400.50	8670083.07	1239.65	FG
94	734396.81	8670077.90	1239.52	FG
95	734398.96	8670064.95	1239.46	FG
96	734403.57	8670052.65	1239.40	FG
97	734409.35	8670050.02	1239.27	FG
98	734426.54	8670054.62	1239.60	FG
99	734430.08	8670060.74	1239.64	FG
100	NOT USED			
101	734397.57	8670093.65	1239.59	FG
102	734393.12	8670089.98	1239.48	FG

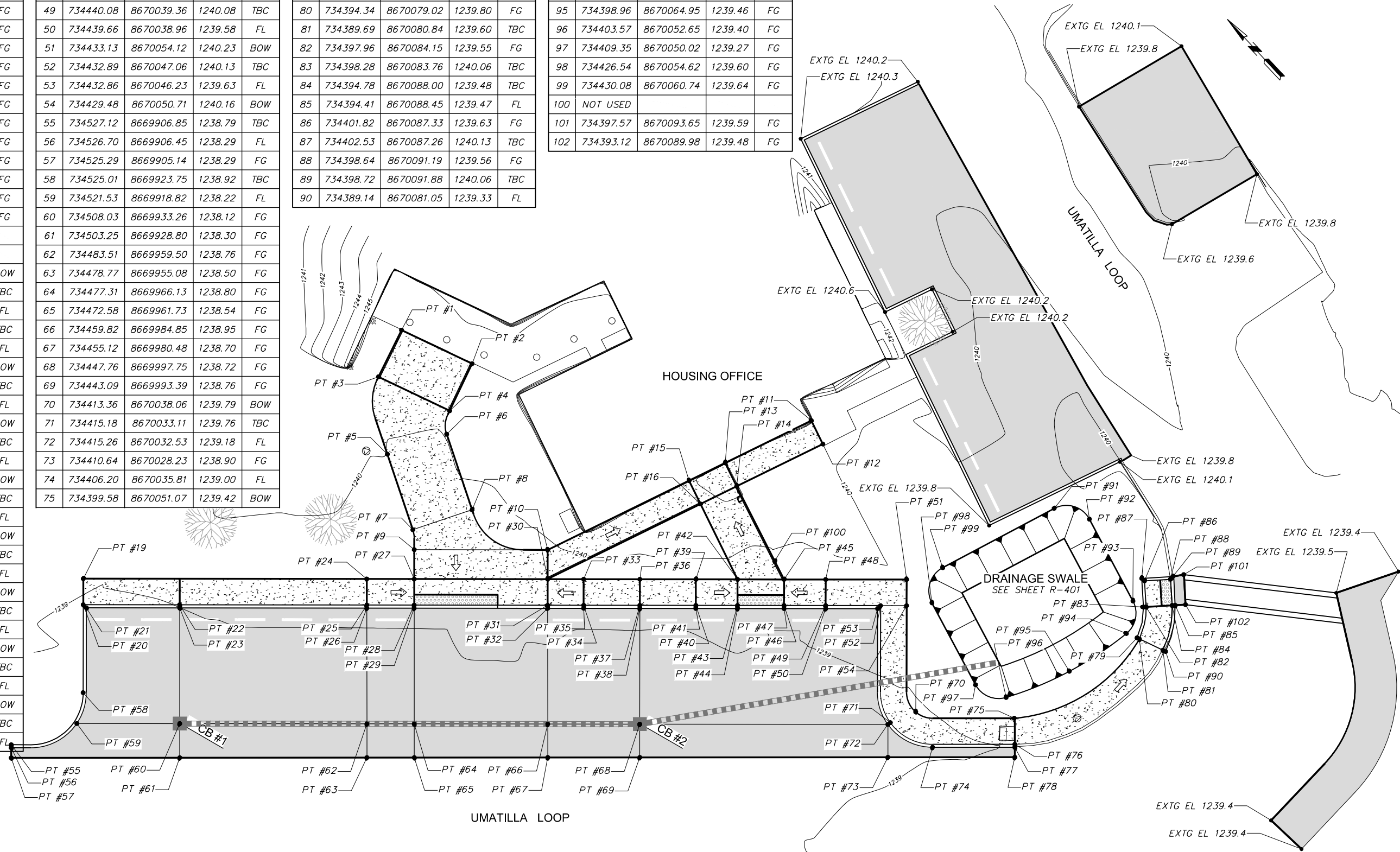

REVISION	BY	DATE
DESIGNED BY: G. BANISTER		JOB NUMBER: 152-214
DRAWN BY: L. WILLHITE		DATE: 2023
REVIEWED BY: A. LINDSEY		ACAD FILE: 152-214-C-102.dwg
COPYRIGHT 2023 BY ANDERSON PERRY & ASSOC., INC.		

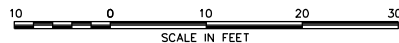

CONFERATED TRIBES OF THE  
UMATILLA INDIAN RESERVATION  
HOUSING OFFICE ACCESS IMPROVEMENTS

SITE  
GRADING PLAN

SHEET

C-102

5 OF 10



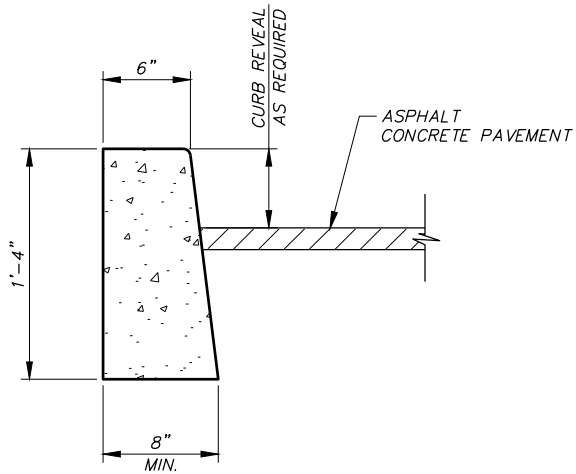

**CONCRETE CURB DETAIL**  
N.T.S.

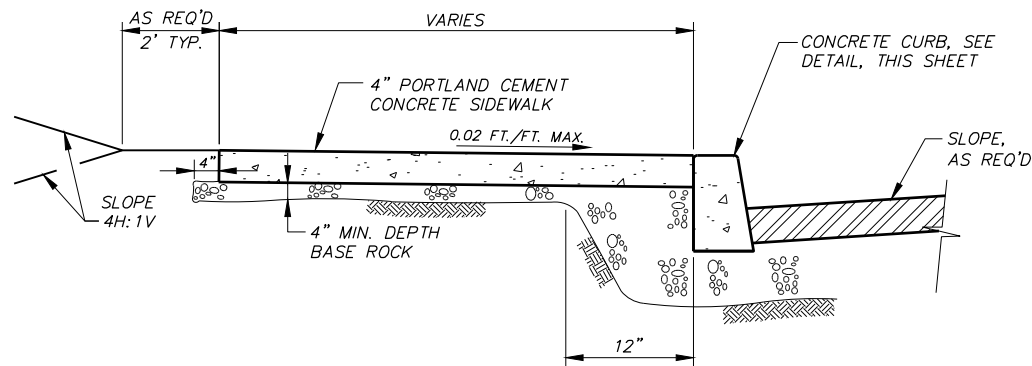

**SIDEWALK DETAIL**  
N.T.S.

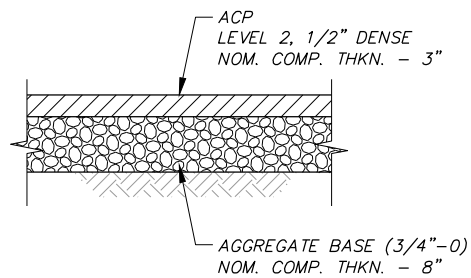

**PARKING AREA TYPICAL SECTION**  
ASPHALT CONCRETE PAVEMENT  
N.T.S.

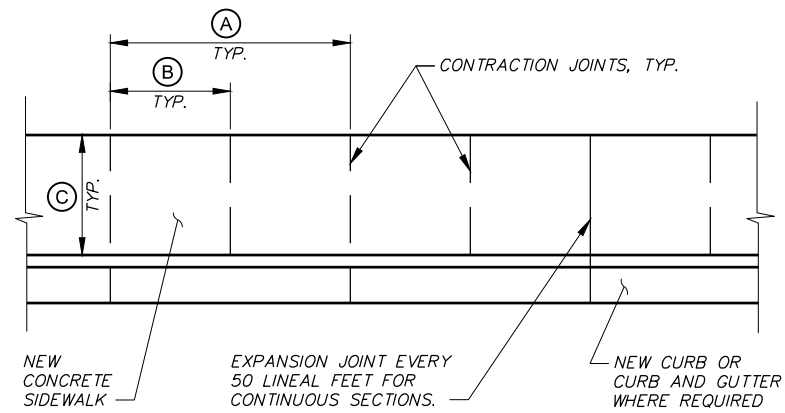

**SIDEWALK/CURB AND GUTTER JOINTING DETAIL**  
(5 OR 6 FEET WIDE SIDEWALKS)  
N.T.S.

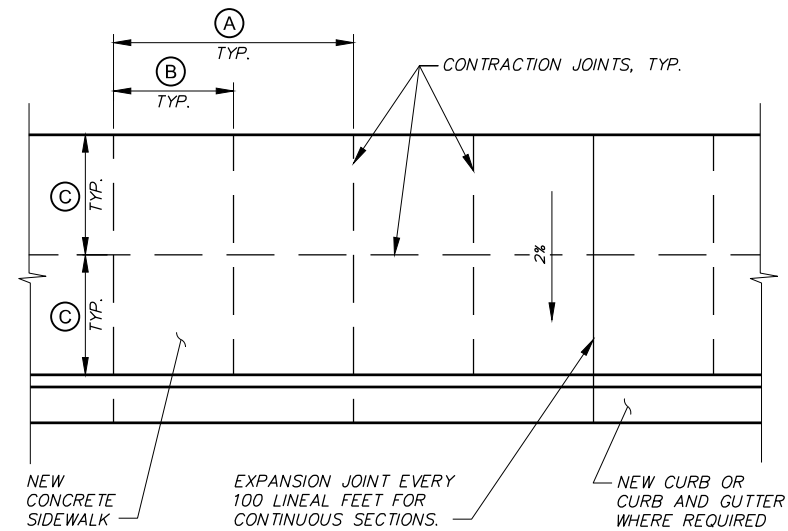

**SIDEWALK/CURB AND GUTTER JOINTING DETAIL**  
(SIDEWALKS GREATER THAN 6 FEET WIDE)  
N.T.S.

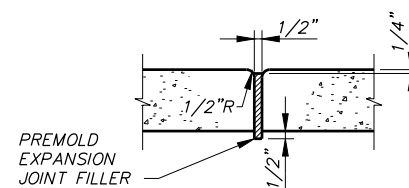

**EXPANSION JOINT**

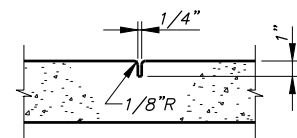

**CONTRACTION JOINT**

**SIDEWALK JOINTING DETAILS**  
N.T.S.

SIDEWALK JOINT REQUIREMENTS				
SIDEWALK WIDTH (FT)	(A) (FT)	(B) (FT)	(C) (FT)	
5'-0"	10'-0"	5'-0"	5'-0"	
6'-0"	12'-0"	6'-0"	6'-0"	
8'-0"	8'-0"	4'-0"	4'-0"	
9'-0"	9'-0"	4'-6"	4'-6"	
10'-0"	10'-0"	5'-0"	5'-0"	
12'-0"	12'-0"	6'-0"	6'-0"	



DESIGNED BY: G. BANISTER	BY:	DATE:	JOB NUMBER: 152-214	DATE: 2023
DRAWN BY: L. WILLHITE			ACAD FILE: 152-214-C-501.dwg	
REVIEWED BY: A. LINDSEY			COPYRIGHT 2023 BY ANDERSON PERRY & ASSOC., INC.	



**CONFERATED TRIBES OF THE  
UMATILLA INDIAN RESERVATION**  
HOUSING OFFICE ACCESS IMPROVEMENTS

SITE  
DETAILS I

SHEET

**C-501**

6 OF 10



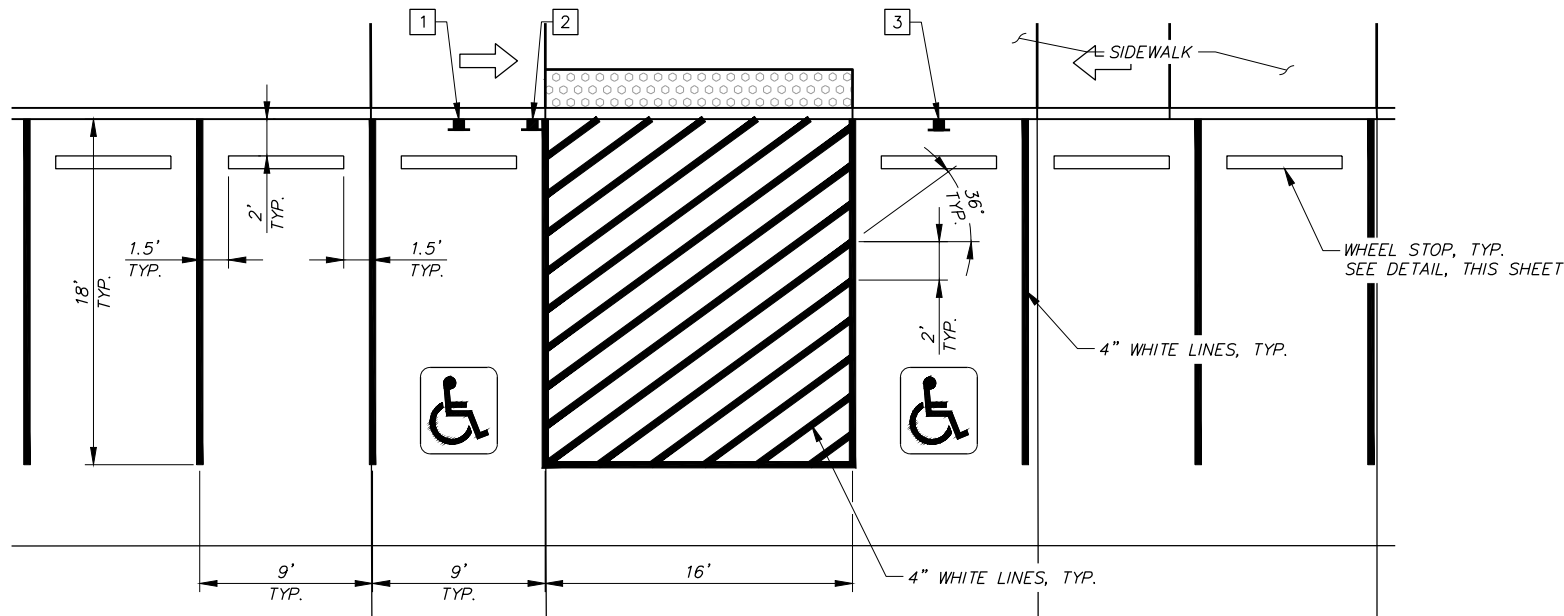
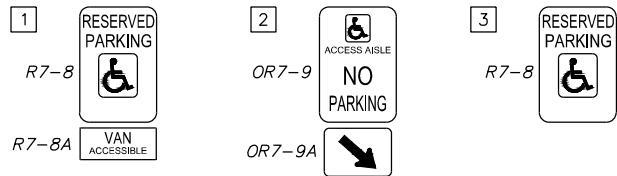

**DOUBLE-ACCESSIBLE PARKING SPACE DETAIL**  
(ONE VAN-ACCESSIBLE DESIGNATION REQUIRED)  
N.T.S.

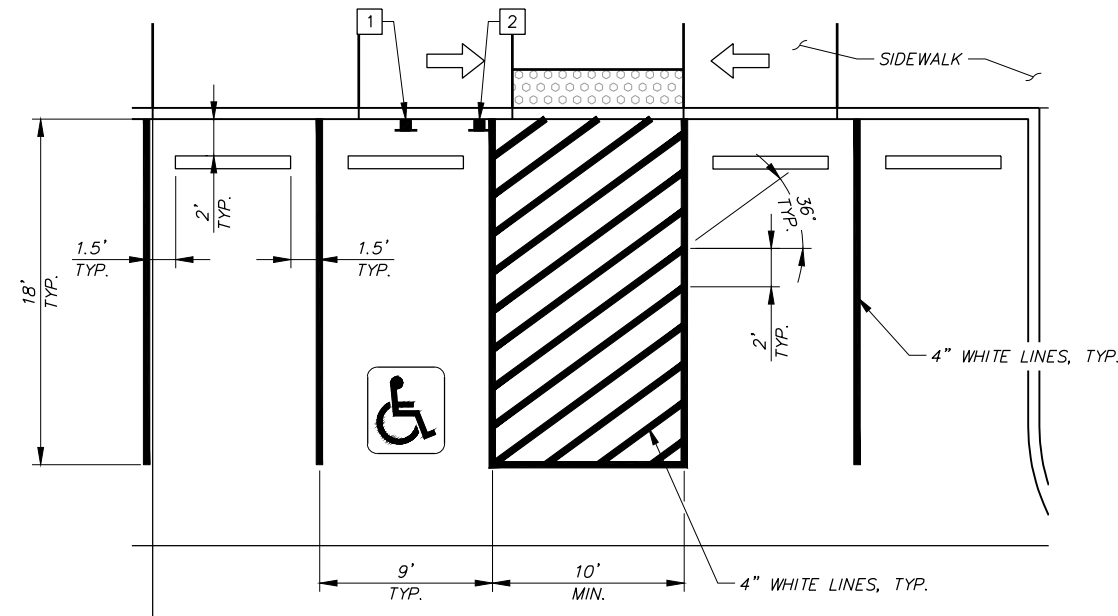
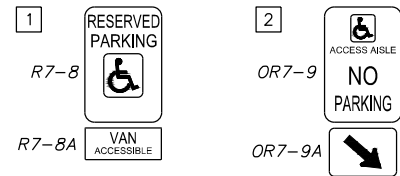

**SINGLE-ACCESSIBLE PARKING SPACE DETAIL**  
(ONE VAN-ACCESSIBLE DESIGNATION REQUIRED)  
N.T.S.

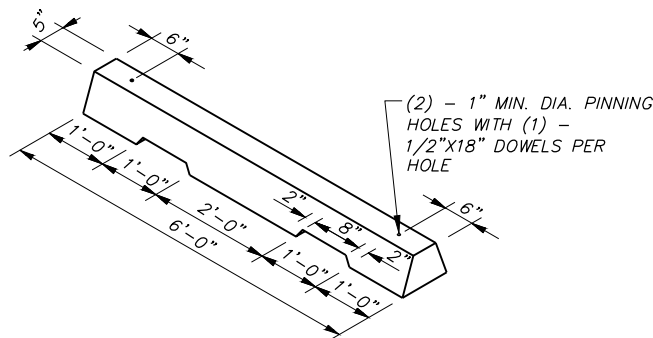

**PRECAST CONCRETE WHEEL STOP**  
N.T.S.

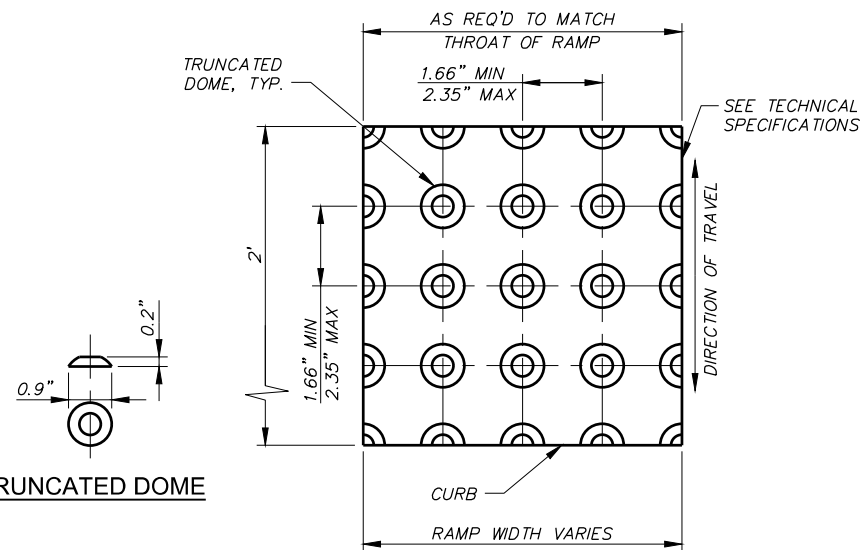

**RAMP TEXTURE PATTERN DETAILS**  
N.T.S.

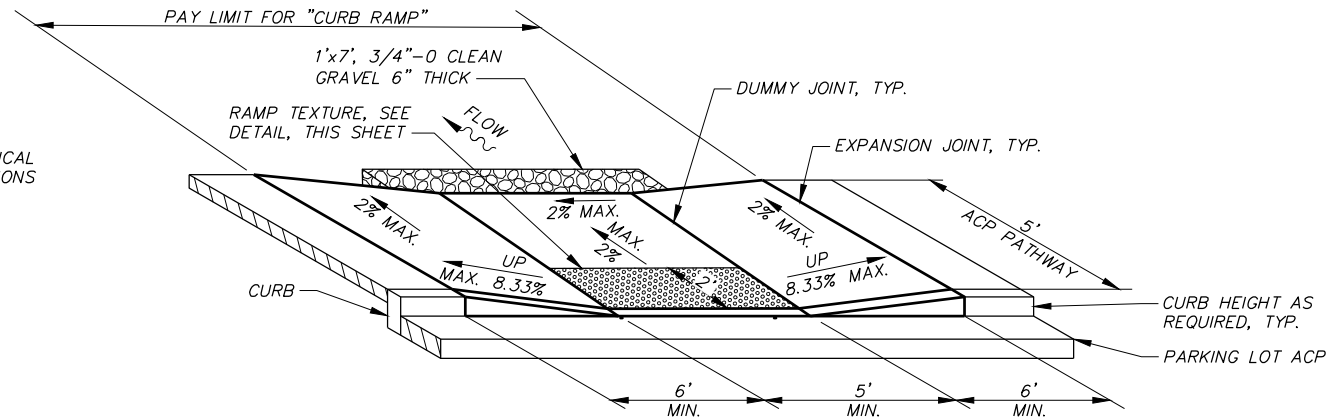

- NOTES**
1. PAYMENT FOR CURB RAMPS SHALL BE INCLUDED IN THE SIDEWALK BID ITEM.
  2. CURB RAMP TEXTURING SHALL BE TRUNCATED DOME WARNING TEXTURE ONLY. IT SHALL ONLY BE PLACED IN THE LOWER 2' OF THROAT OF RAMP. ALIGN PATTERN RELATIVE TO TRAVEL DIRECTION. COLOR OF TEXTURE TO BE SAFETY YELLOW.
  3. CURB RAMP TO ACP TRANSITION SHALL BE FLUSH.
  4. DUMMMY JOINTS AS SHOWN.
  5. RAMP TURN SPACE SHALL BE A SPILL THROUGH CURB AND WALK FROM PARKING LOT TO GRASSY AREA.

**CURB RAMP DETAIL**  
N.T.S.



REVISION	BY	DATE	JOB NUMBER	152-214	DATE	2023
DESIGNED BY	G. BANISTER		ACAD FILE:	152-214-C-502.dwg		
DRAWN BY	L. WILLHITE					
REVIEWED BY	A. LINDSEY					



**CONFERATED TRIBES OF THE  
UMATILLA INDIAN RESERVATION**  
HOUSING OFFICE ACCESS IMPROVEMENTS

**SITE  
DETAILS II**

SHEET

**C-502**

7 OF 10

WORK ITEMS

- ① INSTALL STORM DRAIN PIPE  
SEE DETAIL, SHEET R-501
- ② INSTALL G-2 AREA DRAIN  
SEE DETAIL, SHEET R-501
- ③ CONSTRUCT DRAINAGE SWALE  
SEE DETAIL, SHEET R-401

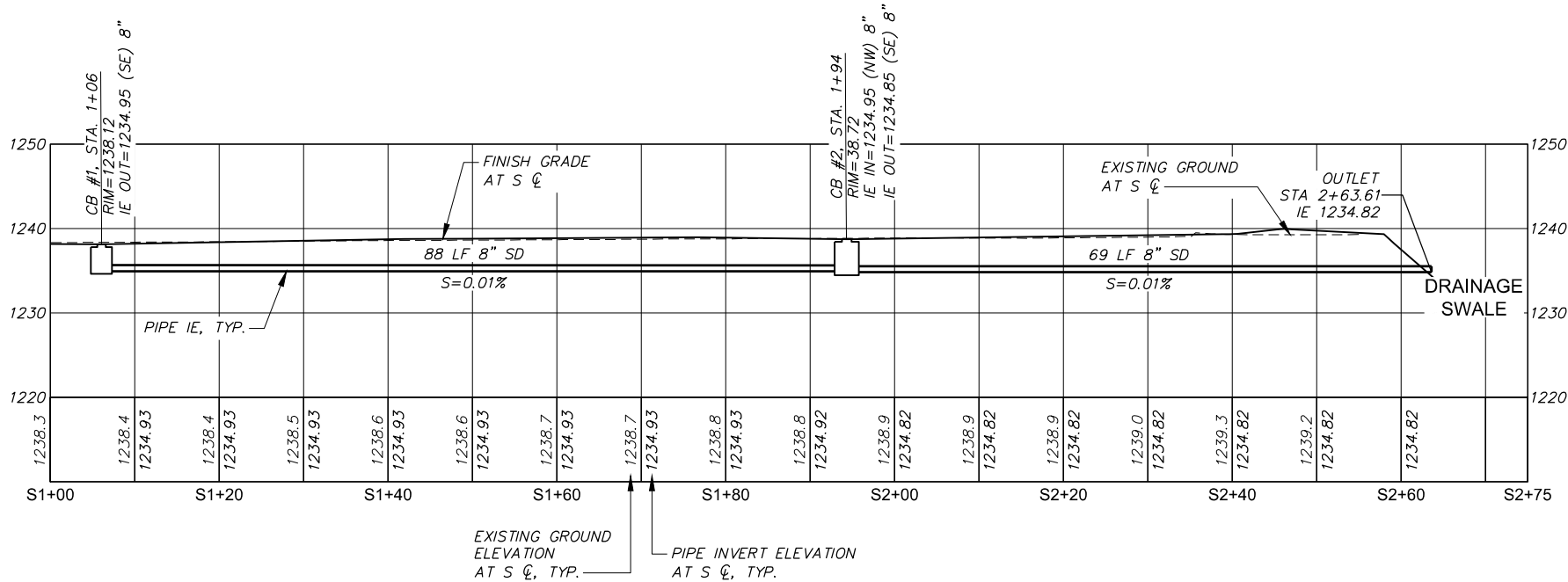
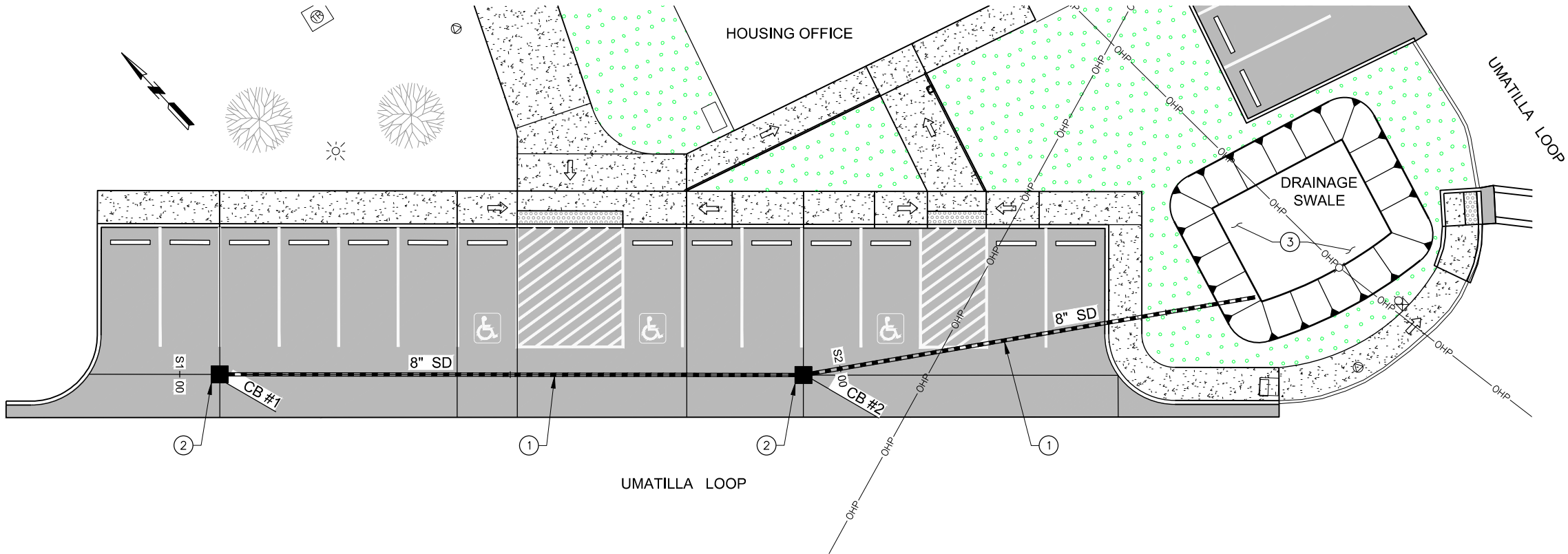

REVISION	BY	DATE
DESIGNED BY: G. BANISTER		
DRAWN BY: L. WILLHITE		
REVIEWED BY: A. LINDSEY		

JOB NUMBER: 152-214	DATE: 2023
ACAD FILE: 152-214-R-101.dwg	
COPYRIGHT 2023 BY ANDERSON PERRY & ASSOC., INC.	

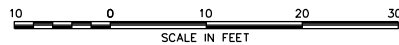

CONFERATED TRIBES OF THE  
UMATILLA INDIAN RESERVATION  
HOUSING OFFICE ACCESS IMPROVEMENTS

STORMWATER  
PLAN AND PROFILE

SHEET

R-101

8 OF 10



X:\Clients\CTUR - Public Works\152-214 Housing Office Access\CAD\152-214-R-401.dwg Layout1, 6/30/2023 2:36 PM, cglmore

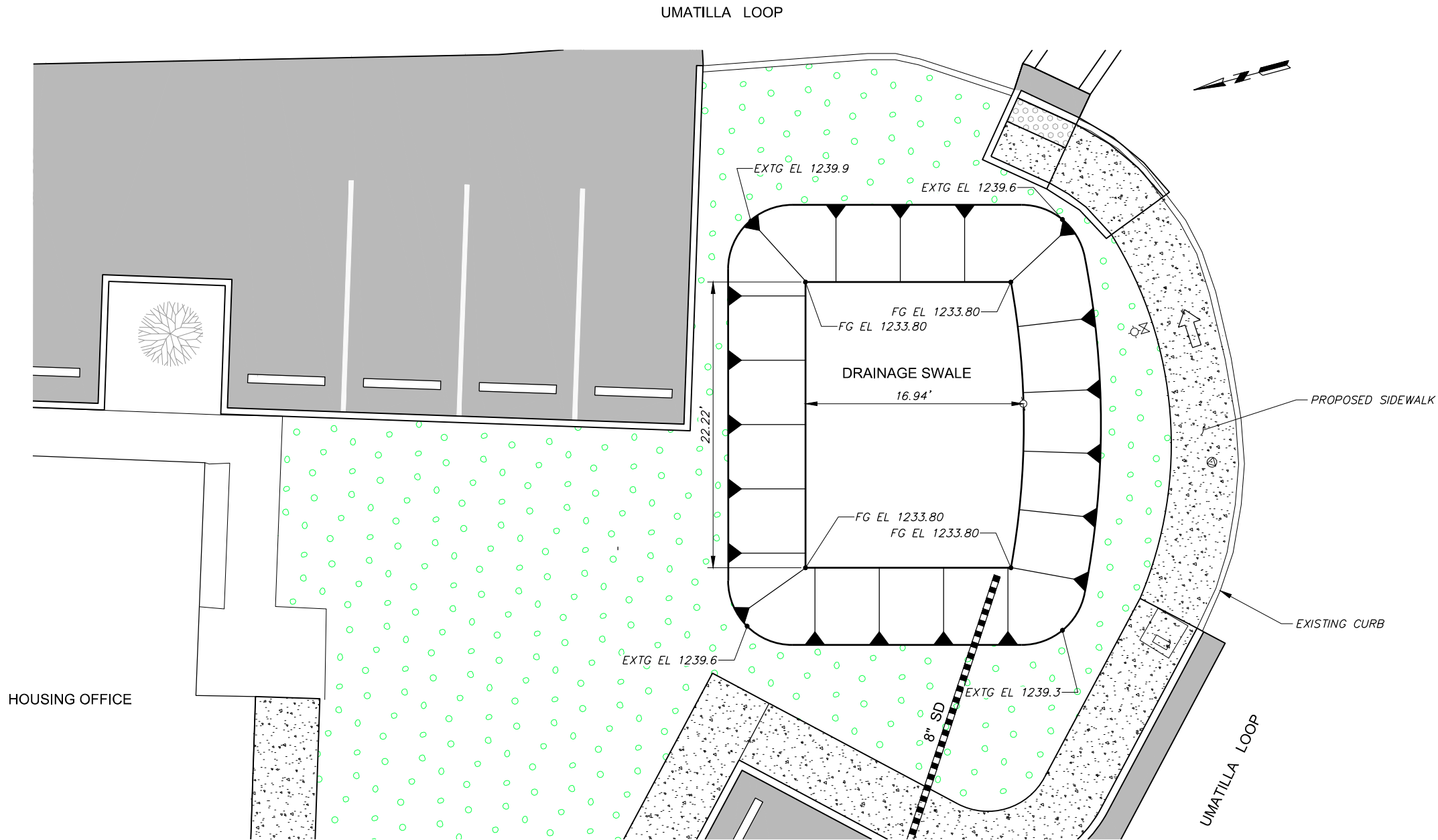

PLAN

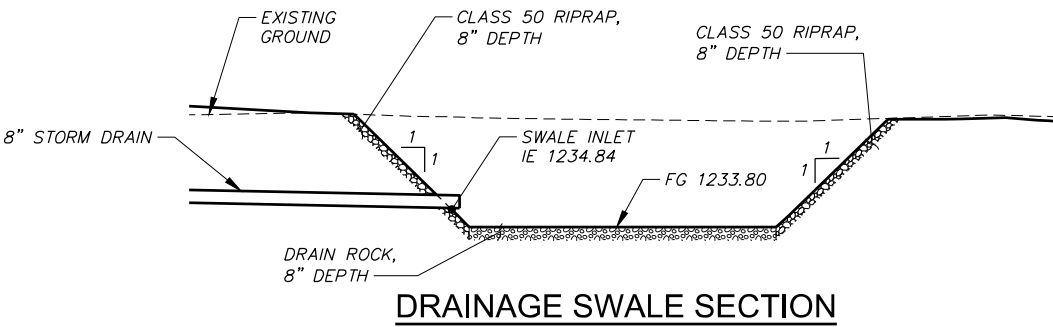

REVISION		BY	DATE
DESIGNED BY: G. BANISTER			
DRAWN BY: L. WILLHITE			
REVIEWED BY: A. LINDSEY			
JOB NUMBER: 152-214		DATE: 2023	
ACAD FILE: 152-214-R-401.dwg		COPYRIGHT 2023 BY ANDERSON PERRY & ASSOC., INC.	

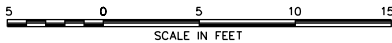

CONFERATED TRIBES OF THE  
UMATILLA INDIAN RESERVATION  
HOUSING OFFICE ACCESS IMPROVEMENTS

STORMWATER  
DRAINAGE SWALE PLAN AND SECTION

SHEET

R-401

9 OF 10

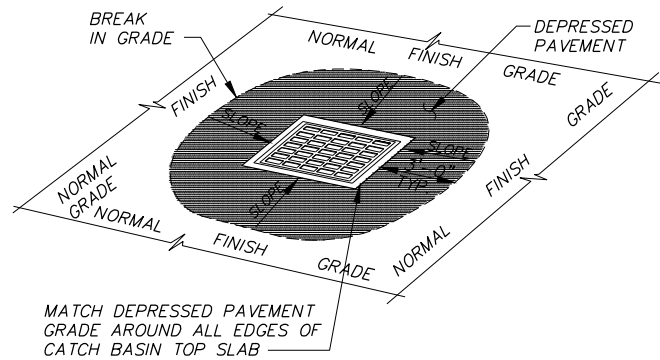

INLET TYPE	L	W
G-1	2'-4" MIN	1'-9" MIN
G-2	2'-4" MIN	2'-3" MIN

NOTE:  
THIS TOP VIEW IS  
CONCEPTUAL ONLY. OUTLET  
PIPE LOCATION MAY VARY.  
CONTRACTOR SHALL VERIFY  
CATCH BASIN AND OIL/WATER  
SEPARATOR SIZES WILL  
ACCOMMODATE ANY OUTLET  
PIPES AT SKEWED ANGLES.

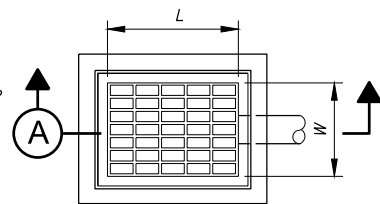

TOP VIEW

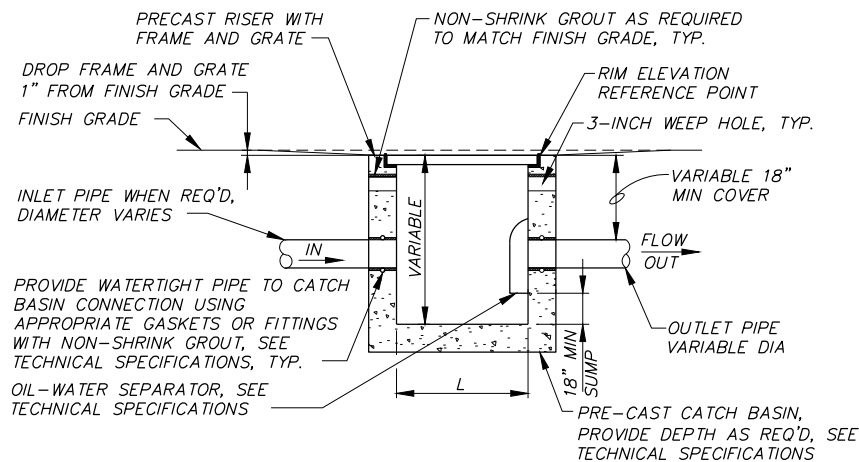

SECTION A

NOTES:

- PRE-CAST CATCH BASINS SHALL BE TYPE G-1 OR G-2 PER OREGON STANDARD DRAWINGS.
- FRAMES AND GRATES SHALL BE TYPE 2 GRATES PER OREGON STANDARD DRAWINGS.
- 6" OF CRUSHED BASE ROCK TO BE PLACED AROUND STRUCTURE.
- REINFORCEMENT SHALL NOT BE REQUIRED FOR CAST-IN-PLACE STRUCTURES. REINFORCEMENT IN PRE-CAST STRUCTURES TO BE REBAR MEETING ASTM A-615 GRADE OR WELDED WIRE MEETING ASTM A-497.
- FIELD SET AREA DRAIN TO OBTAIN PROPER GRATE ORIENTATION WITH FINISH GRADE.
- PRE-CAST BASES SHALL BE FURNISHED WITH CUTOUTS OR KNOCKOUTS. KNOCKOUTS SHALL HAVE A WALL THICKNESS OF 2-INCHES MINIMUM AND MAY BE LOCATED ON ALL FOUR SIDES.

AREA DRAIN DETAIL

N.T.S.

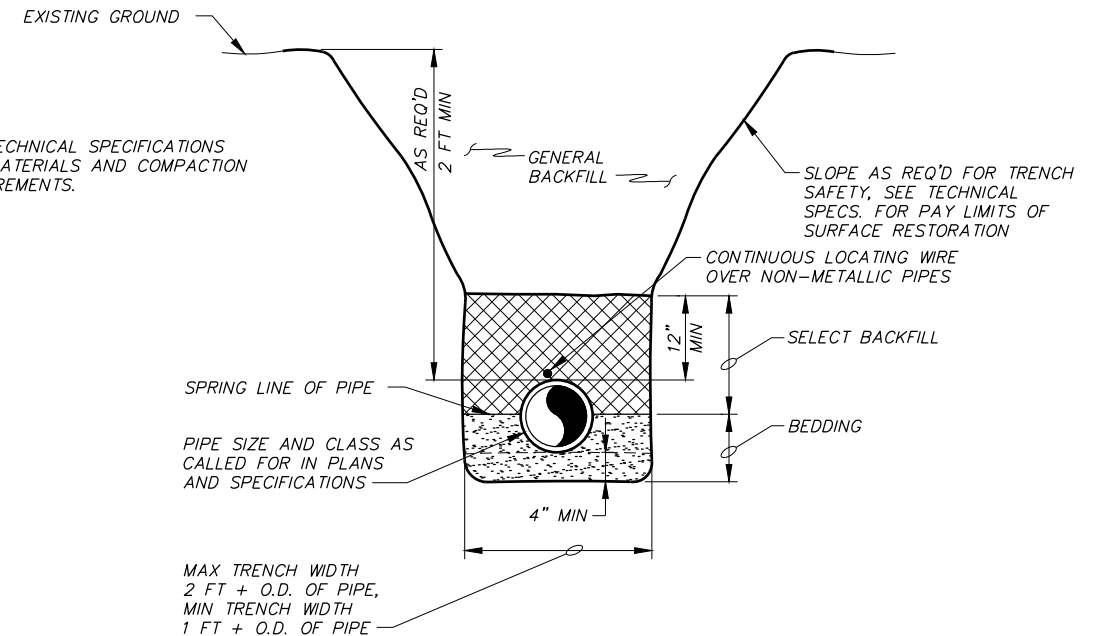

TRENCH EXCAVATION AND BACKFILL  
(WITH LOCATING WIRE)  
N.T.S.



REVISION	BY	DATE	JOB NUMBER	152-214	DATE	2023
DESIGNED BY	G. BANISTER		ACAD FILE:	152-214-R-501.dwg		
DRAWN BY	L. WILLHITE					
REVIEWED BY	A. LINDSEY					



CONFERATED TRIBES OF THE  
UMATILLA INDIAN RESERVATION  
HOUSING OFFICE ACCESS IMPROVEMENTS

STORMWATER  
DETAILS

SHEET

R-501

10 OF 10